

## Inductive distance measuring sensors

### IR08.D03S-11141034

#### dimension drawing

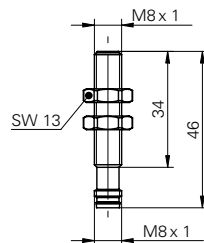

#### general data

mounting type	quasi-flush
measuring distance Sd	0 ... 3 mm
resolution	< 0,001 mm (stat.) < 0,01 mm (dynam.)
repeat accuracy	< 0,02 mm
linearity error	± 300 µm (S = 0 ... 3 mm) ± 90 µm (S = 0,75 ... 2,25 mm)
temperature drift	± 6 % (Full Scale; -10 ... +70 °C) ± 4 % (Full Scale; 0 ... +60 °C)

#### electrical data

response time (factory characteristic)	< 0,5 ms
voltage supply range +Vs	6 ... 36 VDC
current consumption max. (no load)	12 mA
output circuit	current output
output signal	0 ... 10 mA
load resistance	< 35 Ohm/V * (+Vs)
short circuit protection	yes
reverse polarity protection	yes

#### mechanical data

type	cylindrical threaded
housing material	stainless steel
dimension	8 mm
housing length	46 mm
connection types	connector M8

#### ambient conditions

operating temperature	-10 ... +70 °C
protection class	IP 67

#### photo



#### connection diagram

