

Inductive proximity switch

IFRM 06P13G1/S35L

dimension drawing

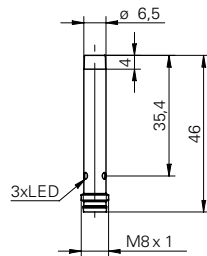

general data

| | |
|--------------------------------|-------------------------------|
| mounting type | unshielded |
| special type | enhanced distance (GammaProx) |
| nominal sensing distance S_n | 6 mm |
| hysteresis | 2 ... 25 % of S_r |
| output indicator | 3 port LED red |

electrical data

| | |
|-----------------------------|------------------------|
| switching frequency | < 400 Hz |
| voltage supply range +Vs | 12 ... 30 VDC |
| current consumption max. | 18 mA |
| output circuit | PNP make function (NO) |
| voltage drop Vd | < 2 VDC |
| output current | < 200 mA |
| short circuit protection | yes |
| reverse polarity protection | yes |

mechanical data

| | |
|-------------------------|--------------------|
| type | cylindrical smooth |
| material (sensing face) | PBT |
| housing material | stainless steel |
| dimension | 6,5 mm |
| housing length | 46 mm |
| connection types | connector M8 |

ambient conditions

| | |
|-----------------------|--------------|
| operating temperature | 0 ... +60 °C |
| protection class | IP 67 |

photo



connection diagram



- 4-fold sensing distance