

# Strain Clamp Set DSRV SET-SOL-170

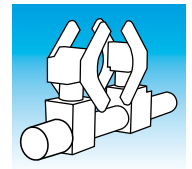

## Contents

Plastic case  
(External dimensions 520 x 530 x 290 mm):

- 1 pc. Y-cable DZCY
- 1 pc. display box DDBF 2-SC  
incl. software *InspectMaster*
- 1 pc. power adapter (battery charger)
- Manual for DSRV, DDBF
- 1 strain clamp  $\varnothing$  30 - 100 mm
- 1 strain clamp  $\varnothing$  100 - 170 mm



## Application

Ideal for machine adjustment

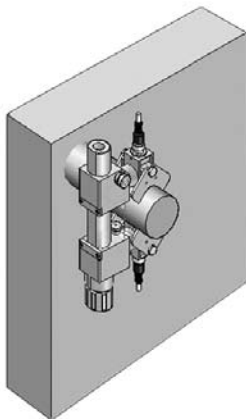

## Description

Portable system for strain measurement on tie bars and shafts. The strain clamps are mounted on the tie bars or shafts. The display box shows the measured strain directly in  $\mu\epsilon$  (strain unit), t or kN.

This set is ideal for machine setter and maintenance people. For casual machine settings and general monitoring on different tie bar diameters.

The set may be used on presses, injection molding and diecasting machines.

## Order code

**DSRV SET-SOL-170**

## Measuring chain

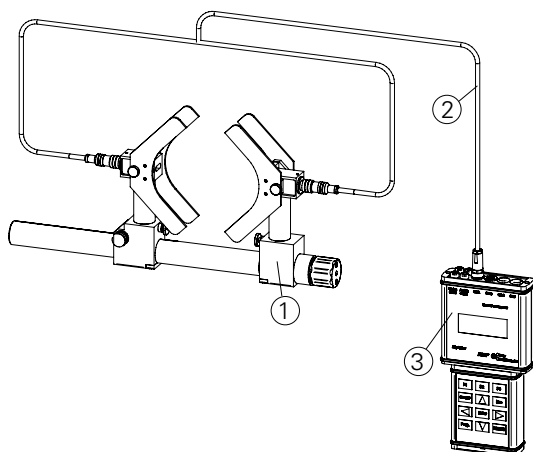

Pos.	Pcs.	Article	Description	Technical data
1	1	DSRV	Strain clamp	page 7.12
2	1	DZCY	Y-cable	page 7.14
3	1	DDBF	Display box incl. power adapter	page 9.4