

Fiber optic sensors & cables

FWDK 10U84Y0

dimension drawing

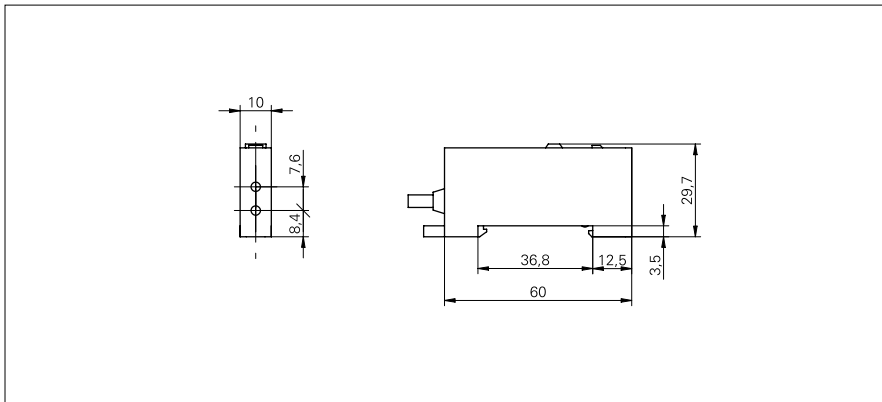

general data

actual range S_b (FSE 200C1002)	90 mm
sensing distance T_w (FUE 200C1003)	25 mm
light source	pulsed red LED
alignment / soiled lens indicator	LED red
output indicator	LED green
adjustment	potentiometer
resolution	0,3 ... 6 % (Full Scale)
wave length	680 nm

electrical data

response time / release time	1 ... 50 ms (adjustable)
voltage supply range $+V_s$	10,8 ... 26,4 VDC
current consumption max. (no load)	40 mA
output circuit	analog 1 ... 5 VDC
load resistance	> 10 kOhm
short circuit protection	yes
reverse polarity protection	yes

mechanical data

width / diameter	10 mm
height / length	29,7 mm
depth	60 mm
type	rectangular
housing material	polycarbonate/ABS
connection types	cable, 2 m

ambient conditions

operating temperature	-20 ... +60 °C
protection class	IP 40

photo



connection diagram

